

T-MAX CHW9000 Mk3

3.56 Tonne Planetary Hydraulic Winch

Car and Commercial Recovery
Ideal for Slide Bed Vehicles

This fast, powerful and reliable machine offers the latest in two stage planetary gear design for quiet reliable operation.

*Designed for foot mounting.
Fully compliant with BS EN14492-1 regulations.*

FEATURES INCLUDE

- **3560kgf line pull**
Rated line pull of 34.9kN
- **BS EN14492-1 compliant**
- **Two stage planetary gearing**
Ideally suited to slidebed vehicles
- **Good recovery speeds**
12 - 17.6m per minute
- **Freespool clutch**
Easy to use T-Bar handle
- **30m rope capacity**
Based on 10mm diameter 1960N/mm² grade, 6 x 36 wire core construction
- **Secure wire rope anchorage**
Simple thread and wrap system for safe installation of wire rope
- **Braking system**
Spring applied brake and motor counterbalance valve supplied as standard to provide 100% braking efficiency
- **Heavy duty roller guide assembly**
With large diameter rollers
- **After sales service**
Technical advice given on winch fitting and component replacement, plus efficient overnight parts despatch and fast repairs.

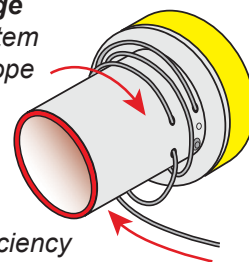

ADDITIONAL EQUIPMENT & SERVICES

- Radio control system to give flexibility in operating the winch up to 40m distance (requires electro-pneumatic valve).
- Wire Rope 10mm diameter 1960N/mm² grade, 6 x 36 wire core construction for maximum flexibility.
- Electro-pneumatic control valve with manual lever and including 7m wanderlead control, heavy duty 16 amp socket, electrical control system with all wiring in Armaflex protection also includes dump valve with emergency stop button ensuring compliance with EU machinery directives.
- Hydraulic oil reservoir tank with filter sight gauge and filler cap, PTO and pump.
- Fitting service can be provided, including load testing and certification.

Bushey Hall Winchmaster sales@bhwgroup.com www.bhwgroup.com

Southern Office: Lismirrane Industrial Park, Elstree Road, Elstree, Herts, WD6 3EE Tel: +44 (0)20 8953 6050

Northern Office: 6 South Orbital Trading Park, Hedon Road, Hull, East Yorkshire, HU9 1NJ Tel: +44 (0)1482 223 663

Bushey Hall Winchmaster is a division of BHW Group Limited. Registered in England No. 1342461 VAT No. 301 7915 80

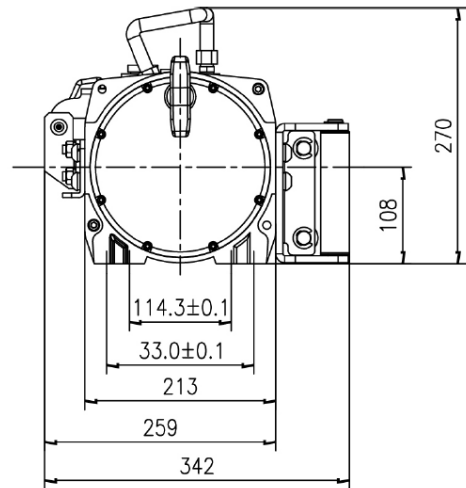
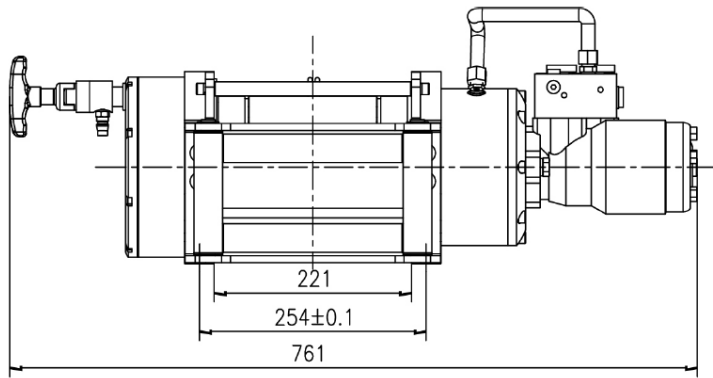

HYDRAULIC PERFORMANCE

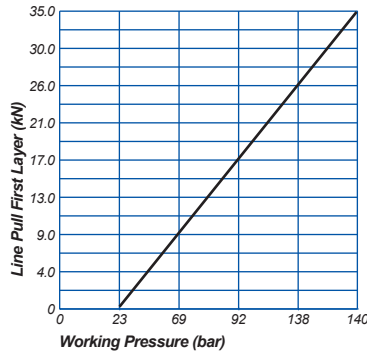
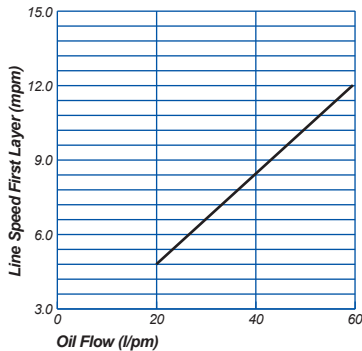

RATED LINE PULL, ROPE CAPACITY, LINE SPEEDS

LINE SPEEDS		LAYER			
		1	2	3	4
Maximum Rated Line Pull by Layer	kN kgf	34.9 3560	29.4 3000	25.4 2600	22.3 2270
CHW9000 Rope Capacity Cumulative by Layer*	m	9	15	25	30
* Line Speed at 60 l/min	m/min	12	14	16	18

* Based on recommended 10mm wire rope and 88cc / rev. motor.

SPECIFICATIONS

Rated Line Pull:	34.9kN (3560kgf), BS EN14492-1 compliant
Line Speed:	12m/min at 60l/min on bare drum
Wire Rope:	23m x 10mm diameter (1960N/mm ² grade, 6 x 36 wire core construction - recommended)
Weight:	Weight of machine: 34kg. With roller guides and rope: 47kg
Gear Reduction: Gear	20.56:1
Type:	Single stage planetary
Winch Construction:	Steel end housings with steel drum
Braking:	Spring applied hydraulic release disc brake and counterbalance valve providing full 100%
Motor:	Braking Low speed, high torque
Drum:	92mm diameter x 218mm length. Flange diameter 208mm
Drum Rotation:	Clockwise, or counter clockwise rotation as required
Freespool Clutch:	Turn spring loaded T-Bar for freespool "in" or "out"
Roller Guides (option):	Heavy duty commercial type with large diameter rollers

NOTE: An open centre motor spool type control valve must be used (all ports open to tank in neutral).

NOTES

These winches must not be used for the movement of personnel and 5 wraps of wire rope must be maintained on the drum.

Data shown is approximate and intended as a guide only.

WARRANTY

Each new winch is guaranteed against defects in workmanship and material defects for a period of twelve months from date of purchase.

Wire ropes are not included under warranty.

Bushey Hall Winchmaster sales@bhwgroup.com www.bhwgroup.com

Southern Office: Lismirrane Industrial Park, Elstree Road, Elstree, Herts, WD6 3EE Tel: +44 (0)20 8953 6050

Northern Office: 6 South Orbital Trading Park, Hedon Road, Hull, East Yorkshire, HU9 1NJ Tel: +44 (0)1482 223 663

Bushey Hall Winchmaster is a division of BHW Group Limited. Registered in England No. 1342461 VAT No. 301 7915 80

